

# MIGRATING CULTURE

**Migrating Culture** is a Design & Build Campaign that promotes Sustainable Building Techniques.

–Together We Can Do So Much More!

*Brought to you by HOPE FOR AFRICA ECO VILLAGE, Ghana.*



---

**Domes for Africa** introduces the Monolithic *EcoShell* Dome-- as a fast, practical way to Build Strong, Permanent Domiciles that can be used for virtually anything.

The Domicile is a Monolithic Cast-Concrete Structurally-Reinforced Shell-- uniquely strong in form and aerodynamics. The Innovative Airform Construction process allows the Dome Buildings to be constructed in numerous shapes and sizes with ease and precision.

Our aim is to re-introduce the Traditional Dome Building Style and Market Dome Homes-- in order to garner general popularity as a viable Housing Module and to act as a Solution towards the current Housing Deficiency throughout Rural Communities.

This Campaign strives to merge social responsibility and for-profit business strategies to develop capacity amongst Rural Entrepreneurs-- ultimately creating self-sufficient Business Entities that Support Community Development.

To date, we've raised the initial Startup Capital for our **Domes for Africa** campaign thru angel investors, crowdfunding and private funds-- with the initial Seed Capital used towards purchasing the Specialized Dome Building Equipment along with Research and Development. This has enabled us to form and train the first Dome Building Cooperative, which is currently building Domes in Ghana-West Africa.

Thank you for taking an interest in our ***Domes for Africa*** Campaign. We are currently seeking impact investors who are interested in supporting our campaign by commissioning their own private Monolithic EcoShell Dome Projects in Ghana.

**Green Building for a Better Tomorrow!**

*Brought to you by HOPE FOR AFRICA ECO VILLAGE, Ghana.*

*There are currently (3) options available in Ghana:*

## Tiny Dome\*

It's not small, it's Tiny!

10 Ft. Round (80 Sq. Ft.) / 10 Ft. Ceiling Height

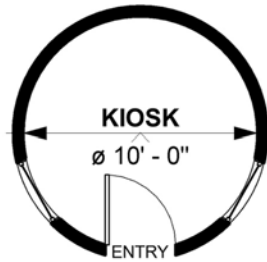

Great for Storage Units, Business Kiosks, Guard Houses, Boys'-Quarters, Restrooms, Granaries, and more....

**Starting @ \$2,500 USD**

**Deposit: \$1,000 USD**

**Construction Period: 4 Weeks**

*\*Additional costs associated with setup fee and site location / conditions.*

## Dome Studio\*

20 Ft. Round (300 Sq. Ft.) / 10 Ft. Ceiling Height

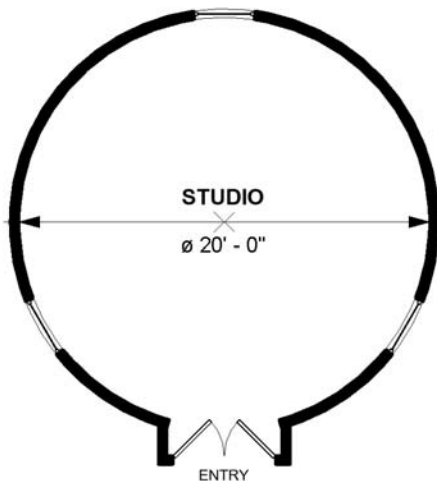

Think of the Dome as a single unit which can be used for virtually anything. Now imagine multiple Dome units clustered together in different patterns and sizes to form spaces for housing, business, and more.

**Starting @ \$10,000 USD**

**Deposit: \$5,000 USD**

**Deluxe Model (With Bathroom & Kitchenette) Starting @15,000 USD**

**Add a Tiny Dome Extension: \$2,000 USD**

**Construction Period: Approx. 3-4 Months**

*\*Additional cost associated with setup fee and site location / conditions.*

## Dome Home\*\*

30 Ft. Round (700 Sq. Ft.) / 20 Ft. Ceiling Height

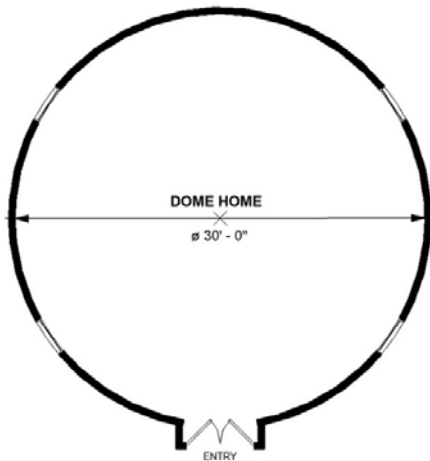

This larger Dome can suit many purposes and are more comparable to a One Bedroom Apartment. Now imagine this larger Dome clustered together with the Dome Studio and Tiny Domes to form spaces for housing, business, and more.

**Starting @ \$20,000 USD**

**Deposit: \$10,000 USD**

**Construction Period: Approx. 4-6 Months**

*\*Additional cost associated with setup fee and site location / conditions.*

**\*\*Special Order\*\***

## The BIG Dome\*\*

40 Ft. Round (1,250 Sq. Ft.)

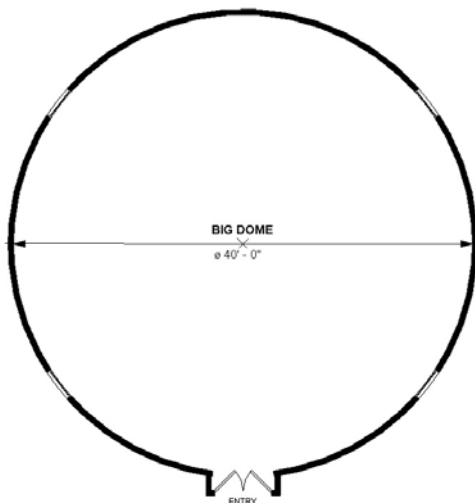

This is the Biggest Single Dome that we can build—it's a wonderful space that can be used as a 2-3 Bedroom Home or as Classroom /Workshop Space.

**Starting @ \$30,000 USD**

**Deposit: \$15,000 USD**

**Construction Period: Approx. 6 Months**

*\*Additional cost associated with setup fee and site location / conditions.*

**\*\*Special Order\*\***

---

## **Main Requirements:**

---

- Ownership of Land in Ghana.
- Available Project Funds.

---

## **:::Waiting List:::**

---

**Please Sign Up in Early!**

***PLEASE BE ADVISED:***

*Due to our current involvement with existing projects there is currently a six (6) Month Waiting list— wherein will utilize this period to Design, Estimate and apply for Local Building Permit so that we can Begin Construction promptly.*